

Pedal Controller Guide

NSA Tuning Systems

» Content

Scope of delivery	2
General information	3
About us	4
Overview Remote	5
Installation & Launch	6
Individual tuning with PerfectTune	7
Programs & Settings	8
Battery and charging	12
Safety instructions	13
Troubleshooting	14
Conformity	15



» Scope of delivery

Remote Control
Base module
Manual
Adhesive pads
Cable ties

» General information

The Pedal Controller is used to change the characteristic of the throttle pedal. By changing the configuration, the characteristics of the throttle pedal can be individually configured and optimised for the specific vehicle, deviating from the standard setting.

This manual provides important information on how to use the Pedal Controller.

A prerequisite for proper functioning is compliance with all the safety instructions and handling instructions given.

Read these installation instructions carefully before installation so that you can benefit from all the technical advantages of the system in the long term.

Only carry out the installation if you have read and understood these installation instructions. We recommend installation by a professional workshop.

The Pedal Controller has been carefully manufactured and rigorously tested. Please follow all the instructions in this manual so that you can enjoy your Pedal Controller for many years.

Please note that improper or inappropriate use of the Pedal Controller will invalidate the manufacturer's warranty. **Note: Only use the Pedal Controller for the defined vehicle. Never install the system with the ignition switched on. Remove the ignition key. After switching off the ignition, wait 5 minutes until all electrical power consumers are switched off.**

Make sure that the wiring harness of the base does not touch or rub against moving parts or metal parts. Do not make any modifications (lengthening or shortening the wiring harness, etc.) to the Pedal Controller. If malfunctions occur due to cables that are not fixed or improper installation, the manufacturer's warranty will also be invalidated.



» NSA Tuning Systems

We are an official importing company of DTE Systems Germany, and we sell these products on Amazon.com

Thank you for choosing our product. In this manual, we will guide you through the installation process step by step, ensuring a smooth and successful setup of your newly purchased item.

If you encounter any difficulties during the installation process, do not hesitate to contact our customer support for assistance.

Thank you once again for choosing NSA Tuning Systems. We wish you an enhanced driving experience with our product. Happy driving!

» Overview Pedal Controller remote

- 1 Programme button
- 2 Battery status
- 3 Performance level
- 4 Minus button
- 5 Plus button
- 6 Feature button
- 7 Immobilizer
- 8 Limit mode

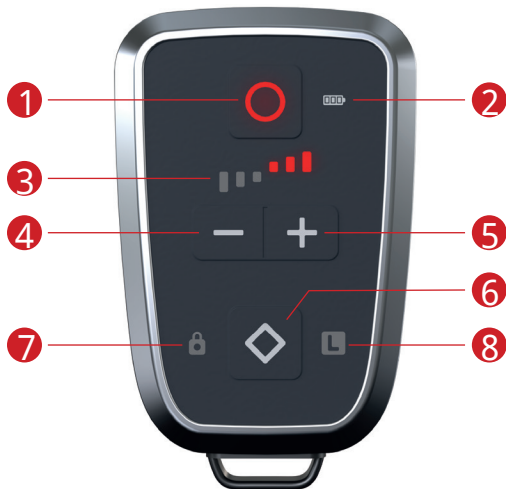

» Installation & Launch

Never install the system with the ignition switched on. Remove the ignition key. After switching off the ignition, wait 5 minutes until all electrical power consumers are switched off.

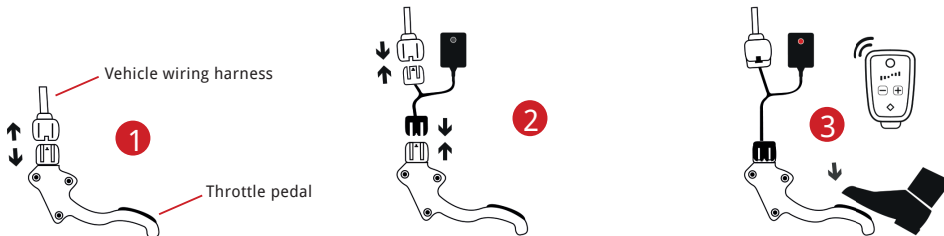

- 1 Disconnect the original plugs of your throttle from the vehicle wiring harness.
- 2 Put the Pedal Controller base in between and connect the Pedal Controller base plugs to the two original throttle plugs.
- 3 To do this, install the Pedal Controller mount with the adhesive pads on the dashboard to the right of the steering wheel (for right-hand drive vehicles to the left of the steering wheel) and insert the Pedal Controller Remote so that it is securely placed in the mount.

Pair the Pedal Controller Remote with the base by pressing and holding the Plus button for several seconds. The programme button and performance level of the remote control now light up blue. The remote control then show you the last setting of your Pedal Controller

The Pedal Controller is now ready for individual tuning with PerfectTune.



Please read the safety instructions on page 14.

» Individual tuning with PerfectTune

How you perfectly match your Pedal Controller to your vehicle



Switch on the ignition. The engine does not have to be running for this procedure. If it is, **make sure your vehicle is in neutral.**



Press and hold the **Plus and Minus buttons together for about 5 seconds.** The performance level shows **all red and green bars.** PerfectTune is now ready to tune to your throttle pedal, the **programmer button flashes white.**



Now slowly press your throttle from neutral to full throttle. With an automatic transmission, you may have to overcome a slight resistance on the last part of the pedal travel (kick-down). Now release the throttle pedal back to the neutral position. You can measure the pedal travel several times by pressing the throttle, **the performance level shows you the throttle pedal position.**















To complete the Perfect Tune tuning, **press the programmer button for 5 seconds.** The Pedal Controller then returns to normal operation and displays the **current programmer on the programmer button.** All programs are now perfectly matched to your throttle pedal.







Please read the safety instructions on page 14.

» Programmes & Settings

Programme selection

-  ECO
Programme button shows green 
-  CITY
Programme button shows violet 
-  SPORT
Programme button shows orange 
-  SPORT PLUS
Programme button shows red 
-  STOCK
Programme button shows white
-  LIMIT MODE
Right LED shows yellow 
-  IMMOBILIZER
Left LED shows green (inactive) / red (active)

Fine adjustment

-  Increase with plus button
Performance level shows red, up to 3 times 
-  Decrease with minus button
Performance level shows green, up to 3 times 



Example: Pedal Controller with Sport Plus programme. The response is three levels higher.

» Programmes & Settings

The Pedal Controller starts with the last selected setting, ex factory with the City programme. With the programme button you can choose between five presets.

Changing programmes

Press the programme button to switch between five preset programmes [CITY, ECO, SPORT, SPORT PLUS and STOCK]. To fine-tune the selected programmer, press the plus button or the minus button.

Overview of the individual programmes

CITY mode is perfectly designed for stop-and-go in city traffic. It ensures improved power in the low rev range.

ECO mode saves fuel on every journey. To achieve this, the programme reduces fuel consumption by limiting aggressive and sporty acceleration. The response is programmed for economical consumption.

SPORT mode already significantly increases throttle response and is suitable for most driving situations. The engine responds more spontaneously: A real plus in dynamics, which the driver feels above all during overtaking manoeuvres.

The **SPORT PLUS** mode has optimised throttle response throughout the entire rev range. The response in this mode is designed for fast starts and rapid acceleration.

In **STOCK** mode, the vehicle is in standard condition.

» Programmes & Settings

Limit mode

Keep yourself and other drivers safe on the road at all times. With Limit Mode, novice drivers in the family or hotel employees have safety and control at all times when driving, especially in powerful vehicles with a lot of traction in the throttle pedal. To do this, the programme reduces the throttle response and limits the opening of the throttle to a certain point.

You can customize the maximum throttle position to approx. 20% (suitable for city traffic/ valet parking), 50% (standard setting) or 80% (prevents strong acceleration).

The limit is set via the plus and minus buttons and can be adjusted in 7 levels. The performance levels light up yellow.



20% Throttle pedal position
(Bar on left lights up)



50% Throttle pedal position



80% Throttle pedal position
(Bar on right lights up)

To activate or deactivate the limit mode, the feature button must be pressed for 5 seconds.



Please read the safety instructions on page 14.

» Programmes & settings

Secure your vehicle additionally with the Pedal Controller and prevent theft by external interference. Each start is only released by Pedal Controller when your associated remote control or paired mobile phone is within range*.

At the same time, Pedal Controller protects you from the well-known security gap of Keyless Go. Many vehicle types make it easy for thieves to override your car key. Pedal Controller does not offer thieves this possibility and thus additionally secures your vehicle against theft.

The throttle pedal is only blocked when the vehicle is restarted. If the immobilizer is active, the Pedal Controller permanently sends values to the engine control unit that correspond to 0% of the throttle pedal position, regardless of whether the driver presses the throttle or not.

If the remote control or a paired Smartphone is found nearby, the immobilizer automatically deactivates until the next restart.

To activate (lock symbol lights up red) or deactivate (lock symbol lights up green) the immobilizer, the feature button must be briefly pressed. The lock symbol lights up green briefly when the blocked throttle pedal is released and then changes to red.



Active



Inactive

Switching off

To switch off, press and hold the programme button until the LEDs of the Pedal Controller go out. Your last settings are automatically saved. Press any button to restart with the last setting



Please read the safety instructions on page 14.

* Depending on the model, the vehicle can still be moved slowly at idle speed.

» Battery and charging

The remote control of the Pedal Controller runs on a rechargeable battery that can be charged via the micro USB port. Before the first use, the battery is charged to about 40%. The battery should be fully charged via the USB port for at least two hours before first use.

One operating cycle takes 30 seconds. The capacity of the battery is sufficient for 280 operating cycles. With normal use with 6-10 operating cycles per day, the battery will last about 4 to 6 weeks.

If the battery status is red, between 10 and 15 operating cycles are still possible. The remote control should then be charged as quickly as possible.

A complete charging process from 0% to 100% capacity takes about 4 hours. The charging process for the Pedal Controller is deliberately rather low in order to ensure a longer battery life.



Please read the safety instructions on page 14.

» Safety instructions

Please note the following information



Never install the system with the ignition switched on. Remove the ignition key. After switching off the ignition, wait 5 minutes until all electrical power consumers have been switched off.

Make sure that all cables are located in such a way that they cannot affect the operation of the pedals. Fix the cable under the fairing, using cable ties if necessary.

Position the Pedal Controller with the enclosed mount in the driver's field of vision on the dashboard so that unintentional or unnoticed operation of the buttons, even by passengers, is impossible.

In any case, only change the setting of the Pedal Controller while your vehicle is stationary and the engine is revving at idle speed. Test the new settings by carefully pressing the throttle pedal to get a feel for the changed sensitivity of the throttle.



Most vehicles have different acceleration and throttle response. Therefore, be mindful and always adjust the Pedal Controller configuration only in small increments (+1 or -1). Never start the Perfect Tune configuration while driving.

Only activate the Limit Mode while your vehicle is stationary and familiarize yourself with the mode in a safe environment.

Ensure that the immobiliser is unlocked before each journey. Always pay attention to road traffic.

If you have any questions regarding installation and safety, please contact your authorized dealer immediately.



Description of error

Troubleshooting

The LED does not light up.

Checked all connected components? Is the Pedal Controller switched on?
Turn on ignition or start the car, problem solved?
None of the above. Contact our customer support.

The car doesn't run smoothly.

Check all connected components.
Are the connectors in the right position?
Are the LED's lit? Have you changed the program?

The EML light is shown or the vehicle goes into LIMP mode.

Reduce the settings using the minus button.
Try an alternate program.
Contact customer support.

Engine light shows up.

Reduce the program by pressing the minus button.

There is no noticeable increase in performance.

Increase the setting using the plus button.
Try a different program.

How do I return to default throttle setting?

The STOCK mode sets the vehicle to default setting.
Turn off the ignition when removing the Pedal Controller. Wait until all electrical consumers are switched off. Remove the Pedal Controller and reconnect the accelerator with the original plug.

» Conformity

The Pedal Controller was developed and produced by DTE Systems, along with the certifications below. Any deterioration of exhaust and noise characteristics of the vehicle in terms of § 19 StVZO German traffic regulations can be excluded due to the Pedal Controller construction. Pedal Controller complies with all applicable safety requirements, including the essential requirements of Directive 2004/108 / EC on the approximation of the laws of the Member States relating to electromagnetic compatibility and applicable test guidelines for auxiliary control devices to modify the accelerator characteristic, in particular 2014/30/EU, EN 50498:2010, 70/157/EWG, VO (EU) 540/2014, 2011/65/EU, 715/2007/EWG, ECE R85, ECE R10, VdTÜV particular 2014/30/EU, EN 50498:2010, 70/157/EWG, VO (EU) 540/2014, 2011/65/EU, 715/2007/EWG, ECE R85, ECE R10, VdTÜV Mb. 751 (01/2018).

If you have questions, contact NSA Tuning Systems

WARRANTY

This Warranty Agreement is provided by NSA Logistics Company for the Pedal Controller and outlines the terms and conditions under which the product is warranted. Please read this Agreement carefully before using your product.

1. This warranty is valid for Pedal Controller units that are directly purchased from NSA Logistics Company. The Pedal Controller, expertly manufactured in Germany by DTE Systems GmbH and denominated by them as PedalBox Pro, is committed to rectifying any manufacturing or material defects that may arise during normal and intended usage.

2. **Warranty Service:** If your Pedal Controller is found to be defective during the warranty period, NSA Logistics Company will, at its sole discretion, repair or replace the defective product with a new unit.

The decision to repair or replace will be made based on the nature of the defect and the availability of parts. This warranty service is provided free of charge, including shipping costs.

3. **Non-Transferable:** This warranty is valid only for the original purchaser of the product and cannot be transferred to any subsequent owners. If the product is resold or obtained from an unauthorized third-party reseller, the warranty becomes void.

4. Exclusions: This warranty does not cover defects, damages, or malfunctions resulting from misuse, abuse, negligence, accidents, unauthorized repairs, modifications, or alterations to the product, or any use that is not in accordance with the product's instructions and guidelines. Additionally, this warranty does not cover normal wear and tear or aging damage.

4.1 If the manufacturer's warranty initially granted for the new vehicles ceases to apply due to the installation of tuning chips/accessories, NSA Logistics Company will not accept any own liability.

4.2 If chips are destroyed or tuning software overwritten (update) due to an incorrect installation, the guarantee is excluded. The same applies with regards to damages caused on the vehicle due to incorrect installations.

4.3 The tuning chip Pedal Controller may only be utilized for the vehicles and motors submitted by the client and in accordance with the notes issued by NSA Logistics Company. The statements regarding performance improvements refer to motors, where the main functions correspond with the mean value, the manufacturer norms and the series-production status.

The customer shall be solely liable for the correctness of their statements. In the case of false statements having been made, the material defects liability of NSA Logistics Company shall not apply.

5. **Warranty Claim Process:** To initiate a warranty claim, contact NSA Logistics Company's customer service at nsalogistics.com. You will need to provide proof of purchase, including the purchase date and the product's serial number. If a repair or replacement is deemed necessary, you will receive instructions on how to proceed.

6. **Limitation of Liability:** To the extent permitted by applicable law, NSA Logistics Company shall not be liable for any direct, indirect, incidental, consequential, or special damages arising out of or in connection with the use or inability to use the product, even if NSA Logistics Company has been advised of the possibility of such damages.

7. **Governing Law:** This Agreement shall be governed by and construed in accordance with the laws of the state of establishment, without regard to its conflict of law principles.

8. **Entire Agreement:** This Agreement constitutes the entire understanding between the parties and supersedes all prior agreements, oral or written, relating to the subject matter hereof.

By using your NSA Logistics Company product, you agree to be bound by the terms and conditions of this Warranty Agreement. If you do not agree with the terms of this Agreement, please return the product to the place of purchase.